

MIRABELLA AT MIRASOL PLAT "C"

A PORTION OF GOLF DIGEST P.C.D.
 A REPLAT OF A PORTION OF TRACT AA, MIRASOL PLAT ONE, AS RECORDED IN PLAT
 BOOK 89, PAGES 14 THROUGH 23 OF THE PUBLIC RECORDS OF PALM BEACH COUNTY, FLORIDA,
 LYING IN SECTION 34, TOWNSHIP 41 SOUTH, RANGE 42 EAST, CITY OF PALM BEACH GARDENS,
 PALM BEACH COUNTY, FLORIDA

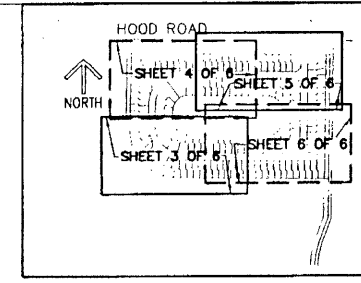

STATE OF FLORIDA
 COUNTY OF PALM BEACH
 THIS PLAT WAS FILED FOR
 RECORD AT _____ M.
 THIS _____ DAY OF _____
 A.D. 2001 AND DULY RECORDED
 IN PLAT BOOK _____ ON
 PAGES _____ AND _____
 DOROTHY H. WILKEN
 CLERK CIRCUIT COURT
 BY: _____
 DEPUTY CLERK

ABBREVIATION LEGEND

- P.R.M. - INDICATES 4" X 4" X 24" PERMANENT REFERENCE MONUMENT MARKED P.R.M. LB#3591
- - DENOTES PERMANENT CONTROL POINT STAMPED - P.C.P. LB#3591
- - DENOTES CENTERLINE
- DE - INDICATES DRAINAGE EASEMENT.
- FND - DENOTES FOUND
- IEE - INDICATES INGRESS AND EGRESS EASEMENT
- WME - DENOTES WATER MANAGEMENT MAINTENANCE EASEMENT
- MEAS - DENOTES MEASURED
- (NR) - INDICATES NON RADIAL LINE.
- N.T.S. - DENOTES NOT TO SCALE
- NO - DENOTES NUMBER
- NPBCD - DENOTES NORTHERN PALM BEACH COUNTY IMPROVEMENT DISTRICT
- ORB - DENOTES OFFICIAL RECORDS BOOK
- PAE - DENOTES PEDESTRIAN ACCESS EASEMENT
- PB - DENOTES PLAT BOOK
- POB - DENOTES POINT OF BEGINNING
- R/W - DENOTES RIGHT-OF-WAY
- SLE - DENOTES SEWER LINE EASEMENT
- WSE - DENOTES WATER AND SEWER EASEMENT
- TWP - DENOTES TOWNSHIP
- TYP - DENOTES TYPICAL
- UE - INDICATES UTILITY EASEMENT.
- (PLAT) - DENOTES MIRASOL PLAT ONE, AS RECORDED IN PLAT BOOK 89, PAGES 14 THROUGH 23 OF THE PUBLIC RECORDS OF PALM BEACH COUNTY, FLORIDA
- (PLAT A) - DENOTES MIRABELLA AT MIRASOL PLAT "A", AS RECORDED IN PLAT BOOK _____ PAGES _____ THROUGH _____ OF THE PUBLIC RECORDS OF PALM BEACH COUNTY, FLORIDA
- (PLAT B) - DENOTES MIRABELLA AT MIRASOL PLAT "B", AS RECORDED IN PLAT BOOK _____ PAGES _____ THROUGH _____ OF THE PUBLIC RECORDS OF PALM BEACH COUNTY, FLORIDA
- ▶ - DENOTES ZERO LOT LINE.
- C1 - DENOTES CURVE TABLE REFERENCE FOR CHORD BEARING AND DISTANCE
- WSE - WATER AND SEWER LINE EASEMENTS
- WMAE - WATER MANAGEMENT ACCESS EASEMENT
- △ - DENOTES CENTRAL ANGLE
- ESMT - DENOTES EASEMENT
- WME - WATER MANAGEMENT EASEMENT

THIS INSTRUMENT PREPARED BY
 DAVID P. LINDLEY
 OF
CAULFIELD and WHEELER, INC.
 SURVEYORS - ENGINEERS - PLANNERS
 7301-A WEST PALMETTO PARK ROAD, SUITE 100A
 BOCA RATON, FLORIDA 33433 - (561)392-1991
 CERTIFICATE OF AUTHORIZATION NUMBER 3591
 FEBRUARY - 2001

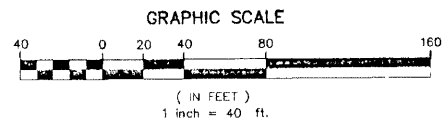
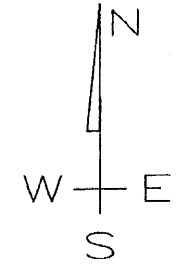

CURVE	CHORD BEARING	DISTANCE
C36	S68°31'24"W	153.07
C37	S40°31'46"W	37.12
C38	S44°08'46"W	283.69
C39	S66°43'54"E	153.63
C40	S21°33'37"E	153.63
C41	S45°51'14"W	281.99
C42	S23°26'18"W	152.51
C43	S68°16'00"W	152.53

